

Technical drawings are subject to change without notice.
 All millimeter dimensions are exact and supersede inch conversions.

Copyright MWE NA Inc., all rights reserved. Reproduction or other use of these designs without written consent from MWE NA Inc. is prohibited.

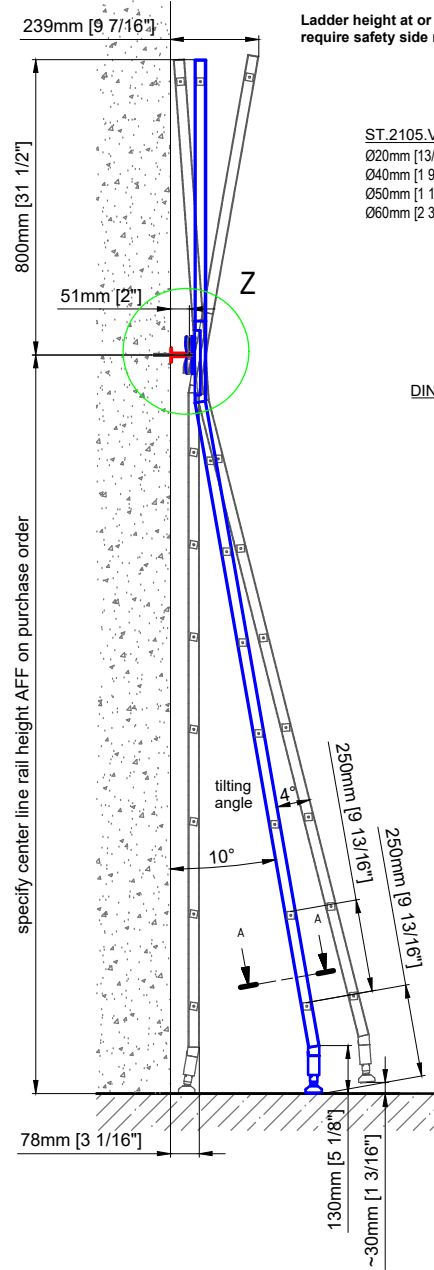
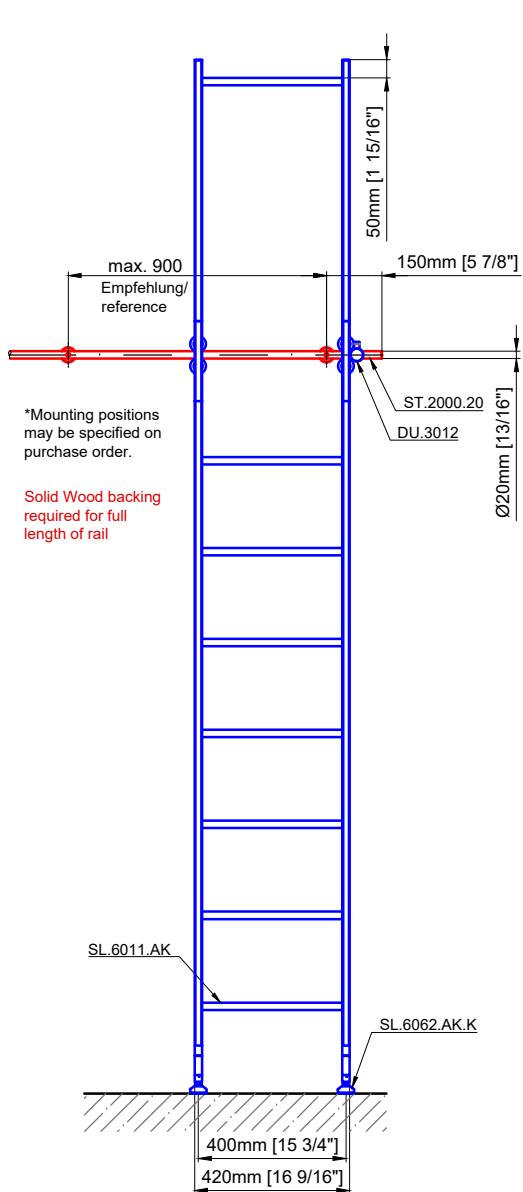

Ladder height at or above 3000mm [118 1/8"] require safety side rails SL.6052.KL

ST.2105.VA -
 Ø20mm [13/16"]
 Ø40mm [1 9/16"]
 Ø50mm [1 15/16"]
 Ø60mm [2 3/8"]

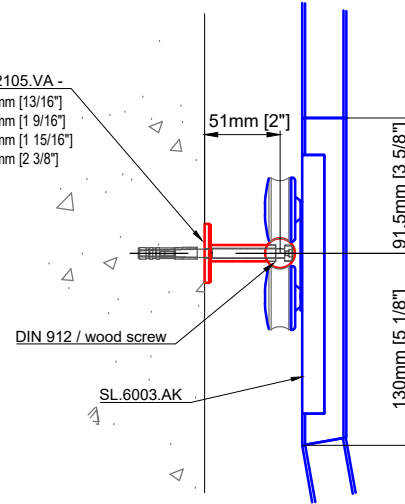

Detail Z

A - A 10°

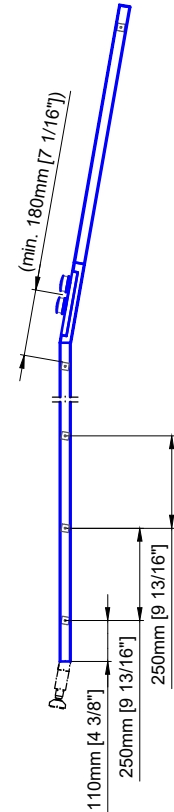
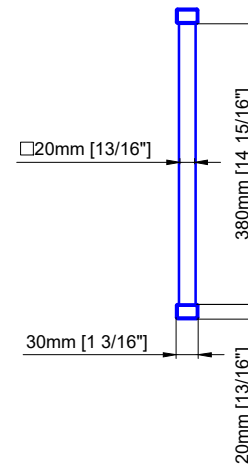

Tangens telescopic slider

SL.6007.AK

Date Prepared: May 2024

Prepared By: AB



Stainless Steel Manufacturer
 NORTH AMERICA

Email: sales@mwe-na.com

www.mwe-na.com

Technical drawings are subject to change without notice.
 All millimeter dimensions are exact and supersede inch conversions.

Copyright MWE NA Inc., all rights reserved. Reproduction or other use of these designs without written consent from MWE NA Inc. is prohibited.

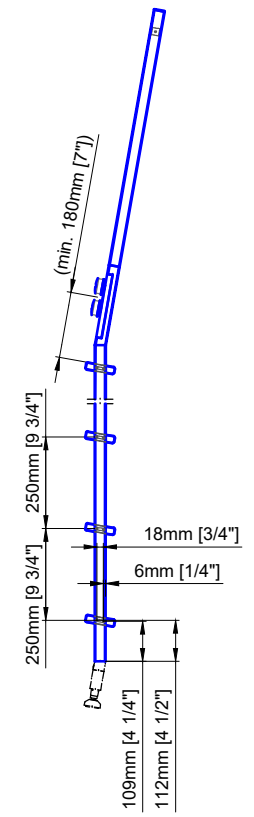
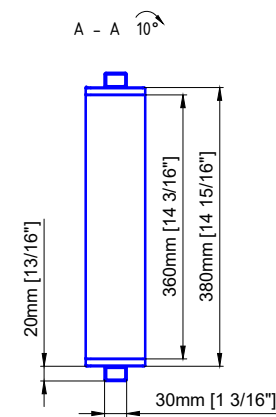
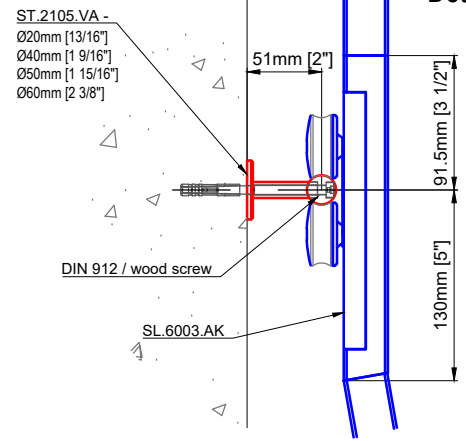
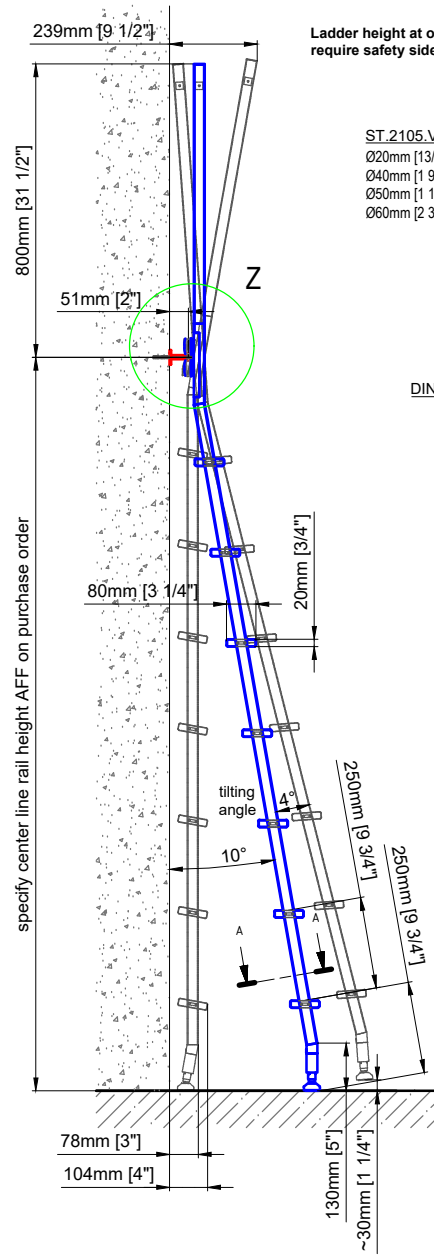
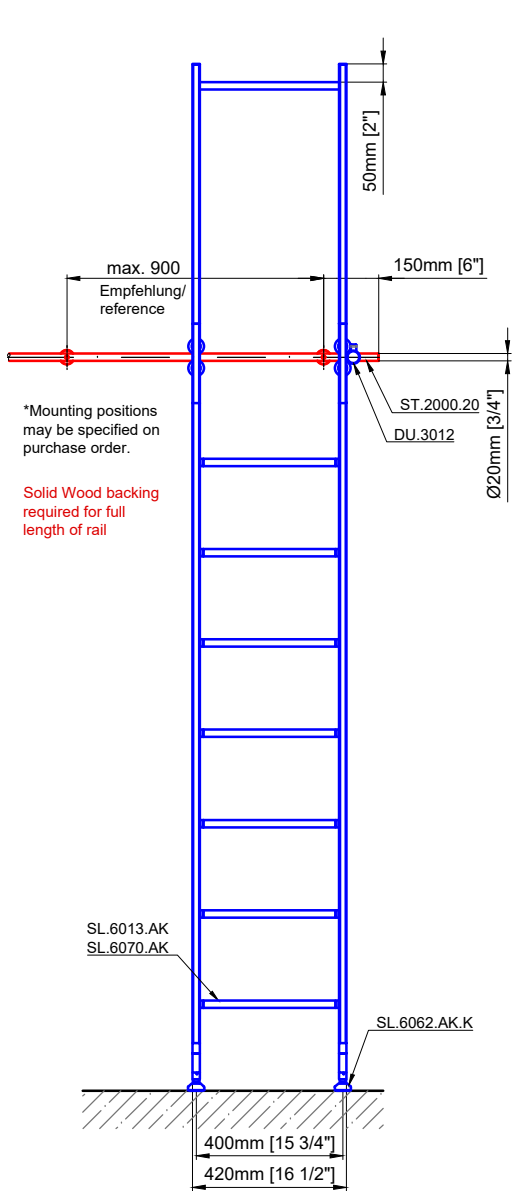

Tangens telescopic slider

SL.6007.AK.E

Date Prepared: May 2024

Prepared By: AB

MWE[®]
 Stainless Steel Manufacturer
 NORTH AMERICA
 Email: sales@mwe-na.com
www.mwe-na.com

Technical drawings are subject to change without notice.
 All millimeter dimensions are exact and supersede inch conversions.

Copyright MWE NA Inc., all rights reserved. Reproduction or other use of these designs without written consent from MWE NA Inc. is prohibited.

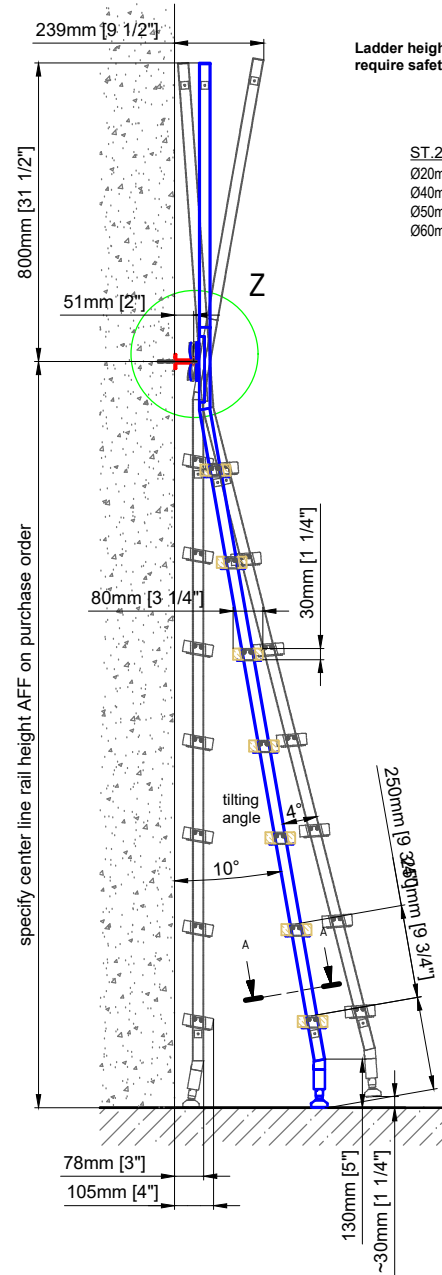
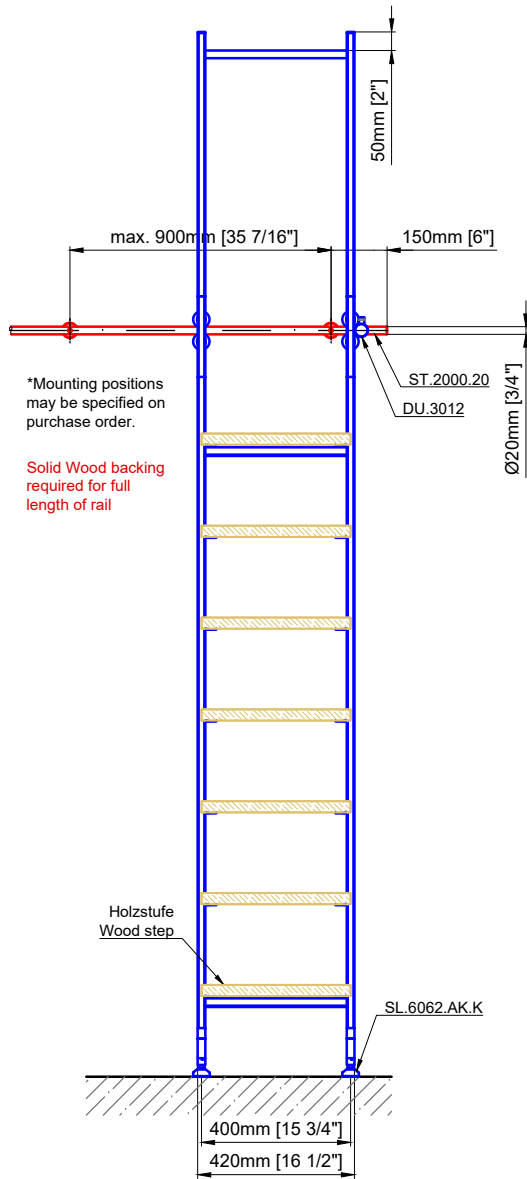

Ladder height at or above 3000mm [118 1/8"] require safety side rails SL.6052.KL

ST.2105.VA -
 Ø20mm [13/16"]
 Ø40mm [1 9/16"]
 Ø50mm [1 15/16"]
 Ø60mm [2 3/8"]

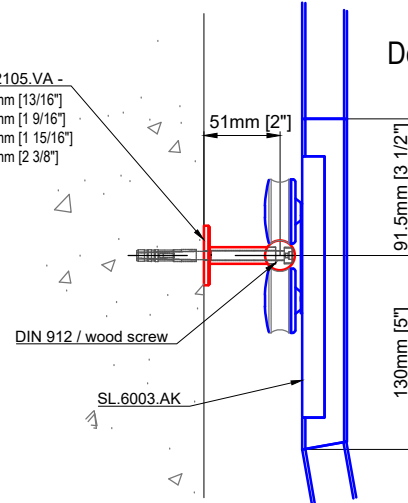

Detail Z

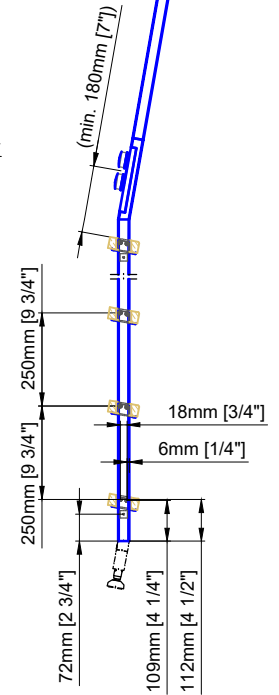

Tangens telescopic slider

SL.6007.AK.H

Date Prepared: May 2024

Prepared By: AB

MWE[®]
 Stainless Steel Manufacturer
 NORTH AMERICA
 Email: sales@mwe-na.com
www.mwe-na.com

Technical drawings are subject to change without notice.
 All millimeter dimensions are exact and supersede inch conversions.

Copyright MWE NA Inc., all rights reserved. Reproduction or other use of these designs without written consent from MWE NA Inc. is prohibited.

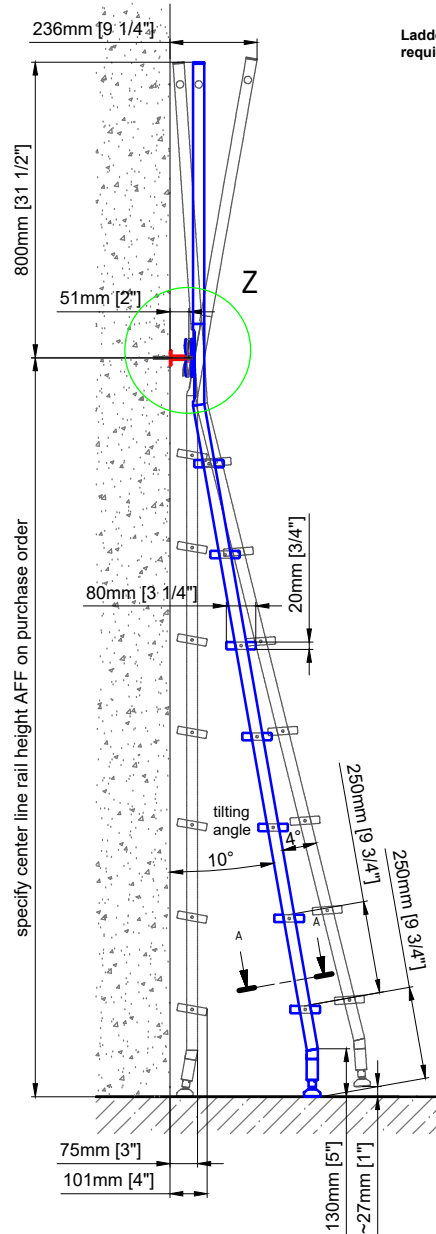
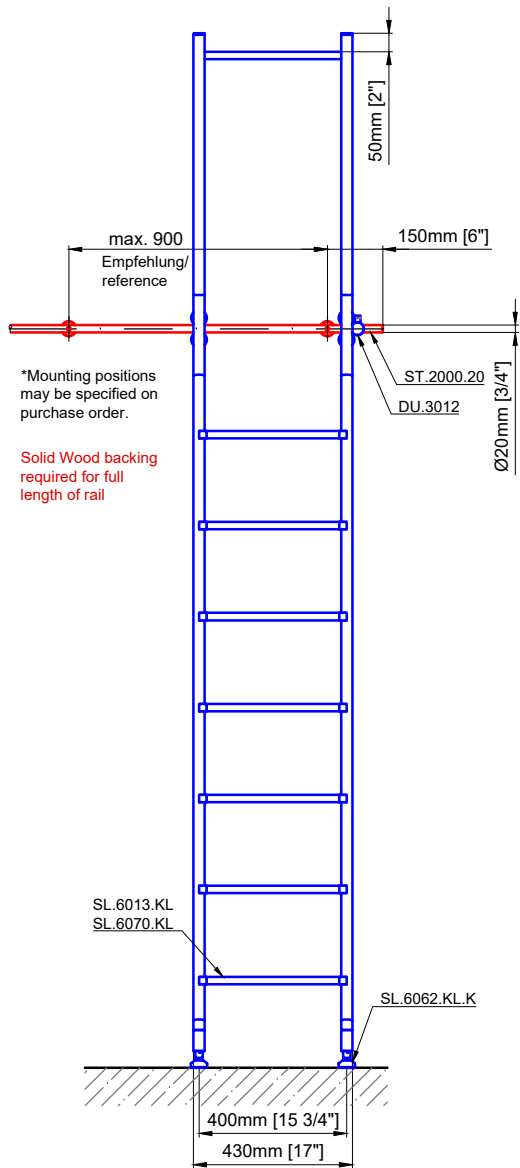

Ladder height at or above 3000mm [118 1/8"]
 require safety side rails SL.6052.KL

ST.2105.VA -
 Ø20mm [13/16"]
 Ø40mm [1 9/16"]
 Ø50mm [1 15/16"]
 Ø60mm [2 3/8"]

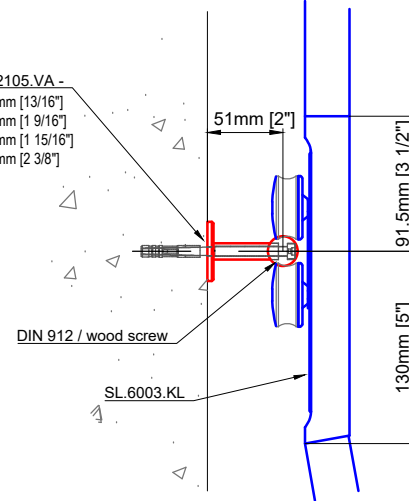

Detail Z

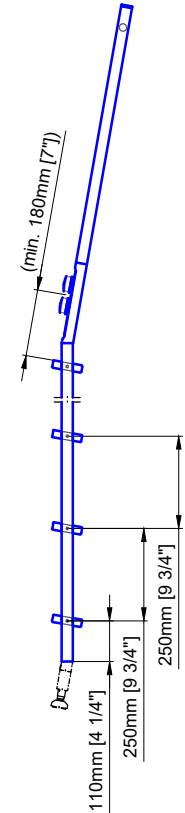
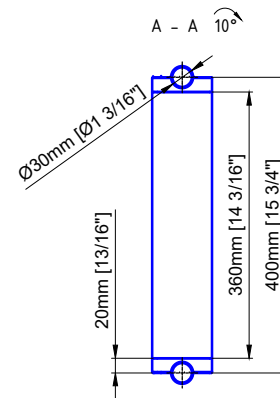

Tangens telescopic slider

SL.6007.KL.E

Date Prepared: May 2024

Prepared By: AB

Technical drawings are subject to change without notice.
 All millimeter dimensions are exact and supersede inch conversions.

Copyright MWE NA Inc., all rights reserved. Reproduction or other use of these designs without written consent from MWE NA Inc. is prohibited.

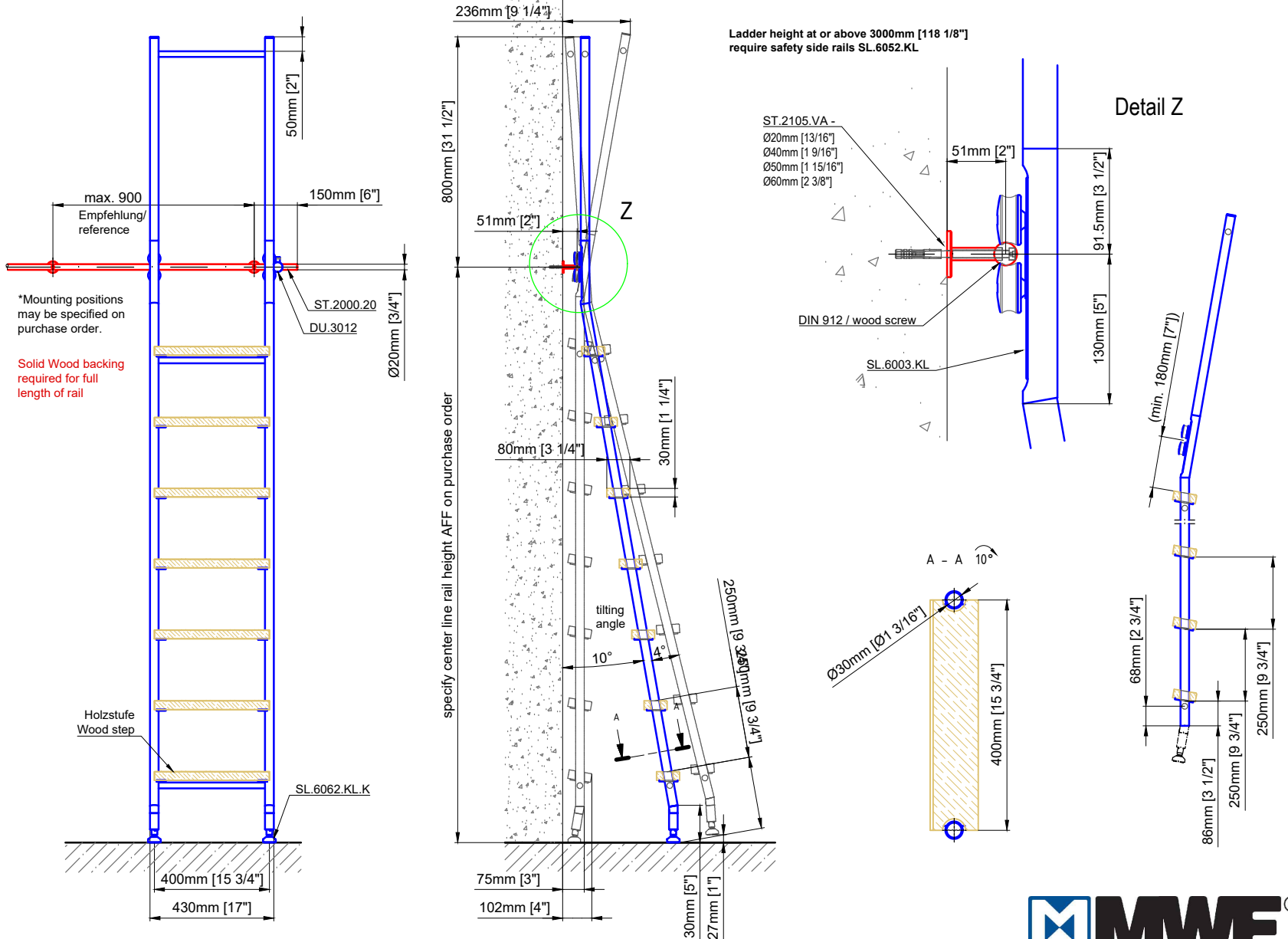

Ladder height at or above 3000mm [118 1/8"] require safety side rails SL.6052.KL

Detail Z

Tangens telescopic slider

SL.6007.KL.H

Date Prepared: May 2024 | Prepared By: AB

MWE[®]
 Stainless Steel Manufacturer
 NORTH AMERICA
 Email: sales@mwe-na.com
www.mwe-na.com

Technical drawings are subject to change without notice.
 All millimeter dimensions are exact and supersede inch conversions.

Copyright MWE NA Inc., all rights reserved. Reproduction or other use of these designs without written consent from MWE NA Inc. is prohibited.

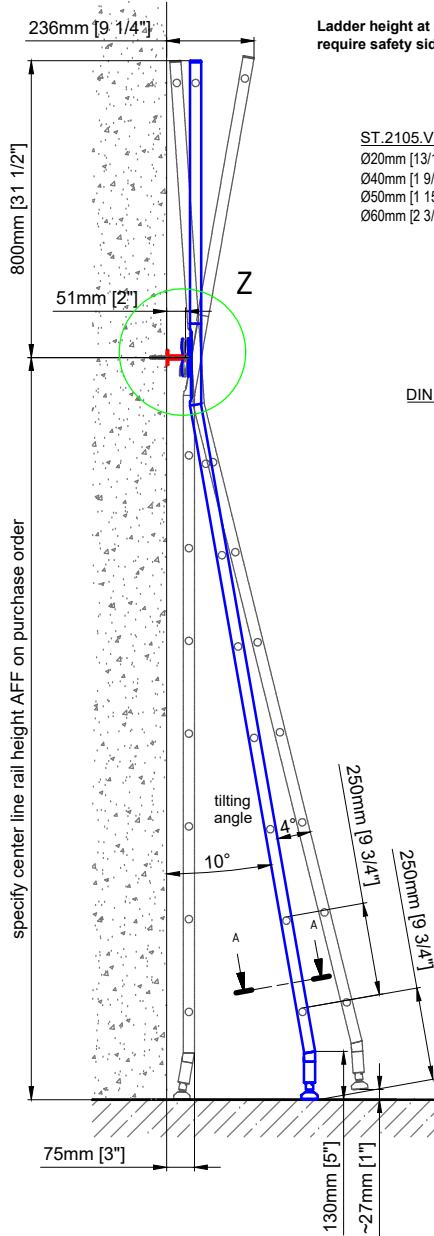
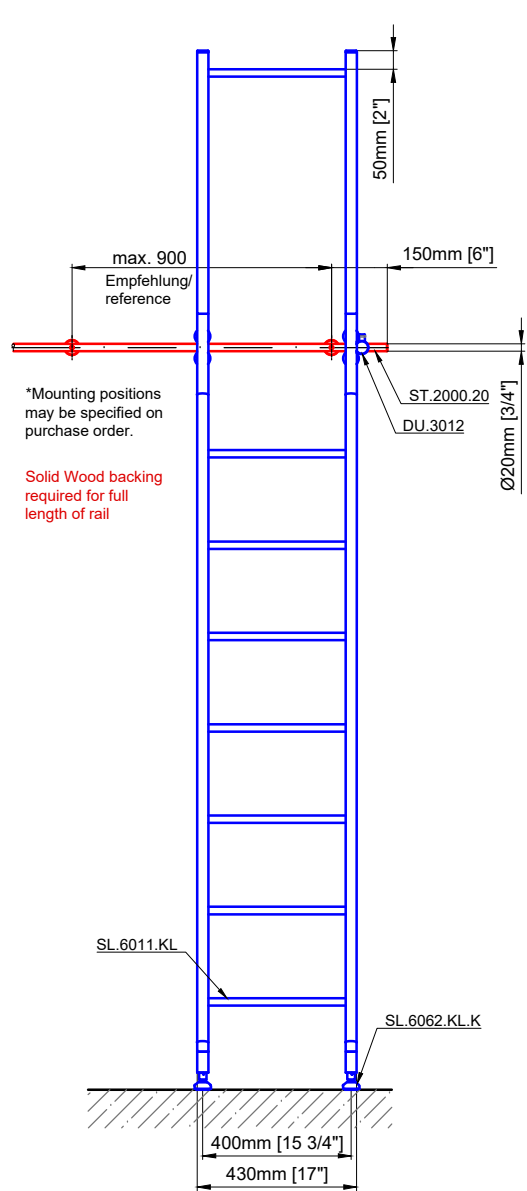

Ladder height at or above 3000mm [118 1/8"]
 require safety side rails SL.6052.KL

ST.2105.VA -
 Ø20mm [13/16"]
 Ø40mm [1 9/16"]
 Ø50mm [1 15/16"]
 Ø60mm [2 3/8"]

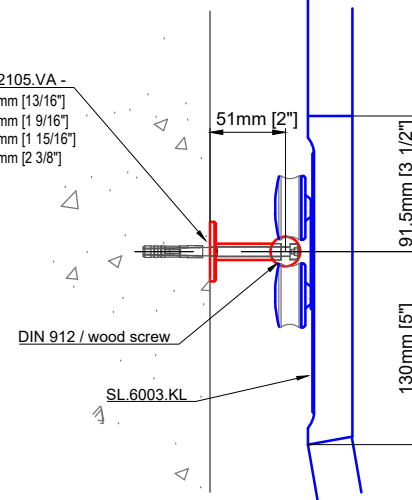

Detail Z

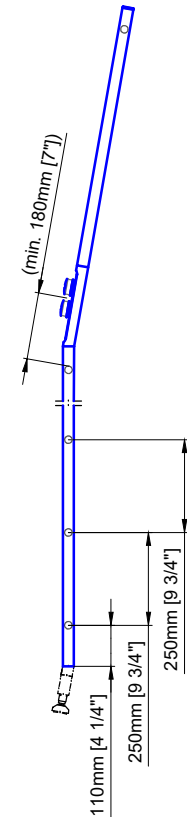
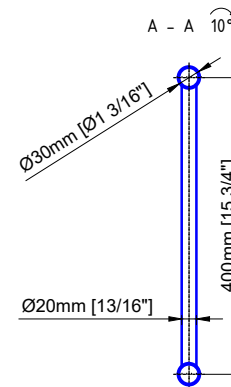

Tangens telescopic slider

SL.6007.KL

Date Prepared: May 2024

Prepared By: AB

MWE[®]
 Stainless Steel Manufacturer
 NORTH AMERICA
 Email: sales@mwe-na.com
www.mwe-na.com