

Load capacity 110lbs
Max. door width 1000mm [39 3/8"]

Illustrated

Right Hinge

Suitable for 8mm [5/16"] - 10mm [3/8"] - 12mm [1/2"] glass

Reference:

3 hinges required for door height at or above 2600mm [102 3/8"]
Third hinge positioned in the upper third of door

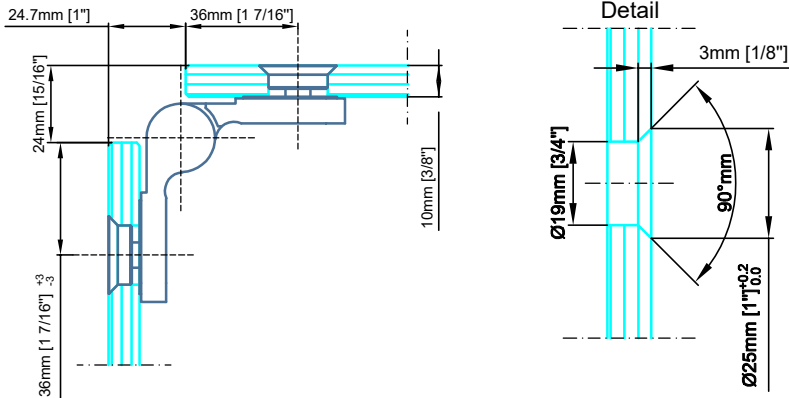

Shown in the open position.
Door lifted max. 6mm [1/4"]

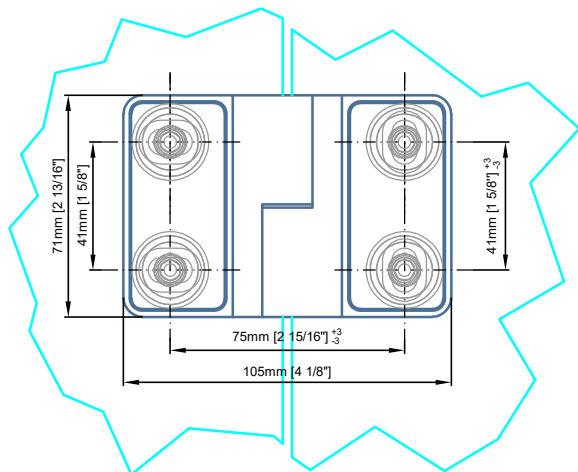
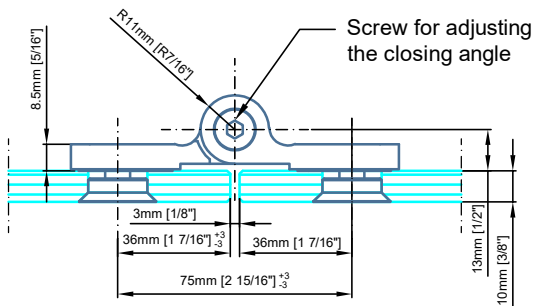

Screws hidden by
a magnetic cover

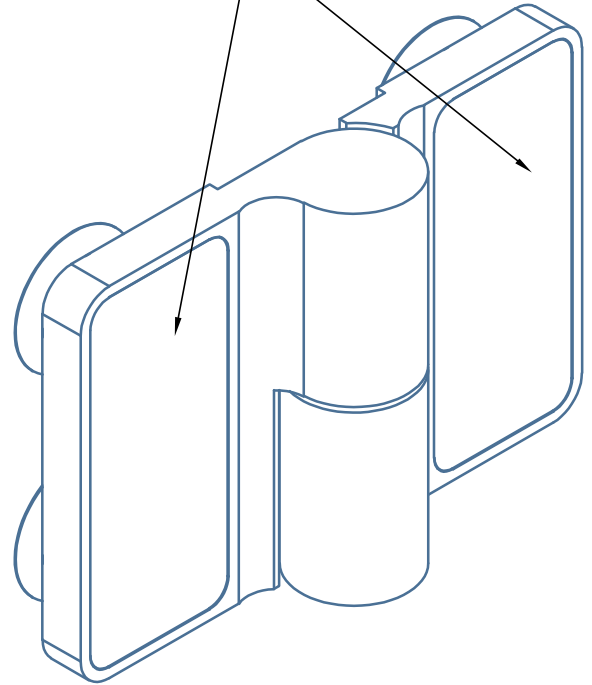

*See specification

Pivot Hinge [DU.3340] Glass to Glass - 180° with seal

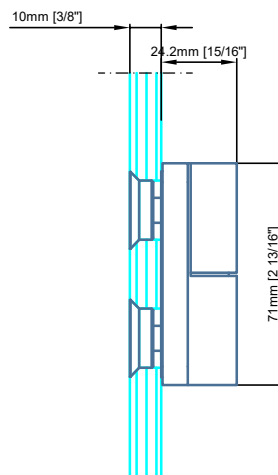

Spirit GGS

DU.3340

Glass to Glass - 180°

Date Prepared: Nov 2018

Prepared By: CDA | JRT

MWE
NORTH AMERICA

Email: info@mwe-na.com
www.mwe-na.com

Load capacity 110lbs
Max. door width 1000mm [39 3/8"]

Illustrated

Right Hinge

Suitable for 8mm [5/16"] - 10mm [3/8"] - 12mm [1/2"] glass

Reference:

3 hinges required for door height at or above 2600mm [102 3/8"]
Third hinge positioned in the upper third of door

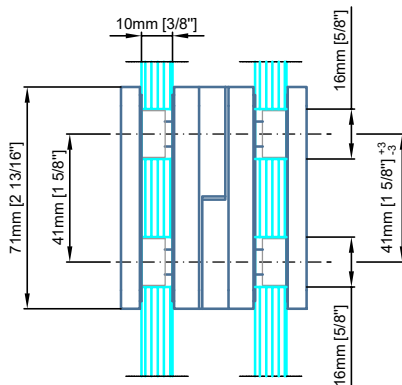
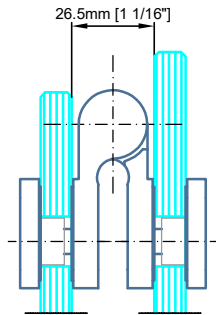
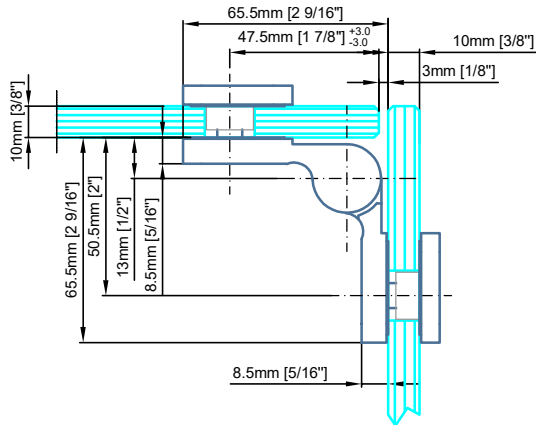

Copyright MWE NA Inc., all rights reserved. Reproduction or other use of these designs without written consent from MWE NA Inc. is prohibited.

Technical drawings are subject to change without notice.
All millimeter dimensions are exact and supersede inch conversions.

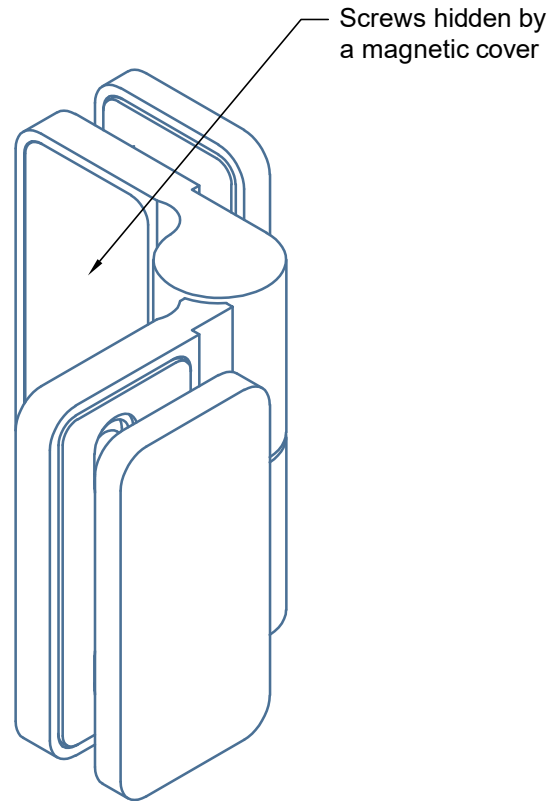

*See specification

Pivot Hinge [DU.3341] Glass to Glass] - 90° with seal

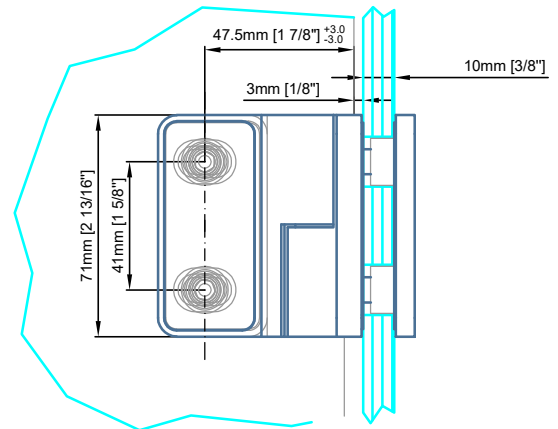

Spirit GGP

DU.3341

Glass to Glass - 90°

Date Prepared: Nov 2018

Prepared By: CDA | JRT

MWE
NORTH AMERICA

Email: info@mwe-na.com
www.mwe-na.com

Load capacity 110lbs
Max. door width 1000mm [39 3/8"]

Illustrated

Right Hinge

Suitable for 8mm [5/16"] - 10mm [3/8"] - 12mm [1/2"] glass

Reference:

3 hinges required for door height at or above 2600mm [102 3/8"]
Third hinge positioned in the upper third of door

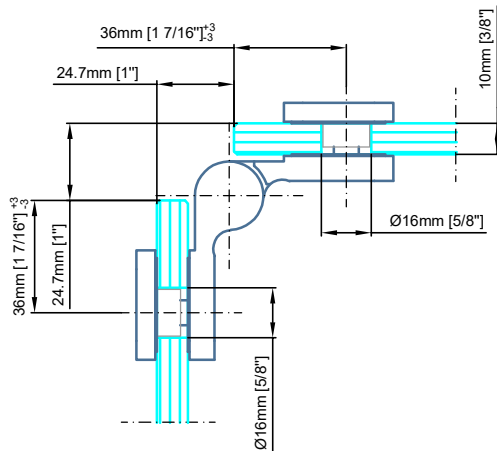

Shown in the open position.
Door lifted max. 6mm [1/4"]

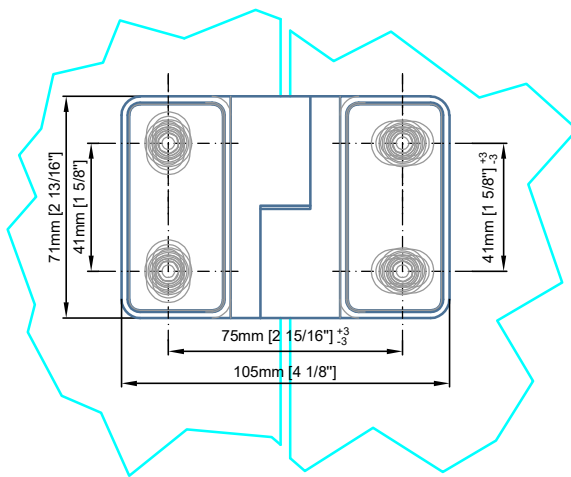
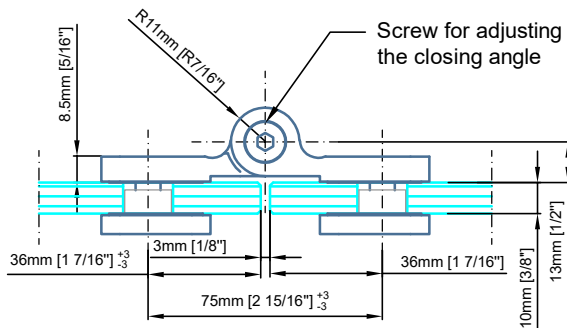

Copyright MWE NA Inc., all rights reserved. Reproduction or other use of these designs without written consent from MWE NA Inc. is prohibited.

Technical drawings are subject to change without notice.
All millimeter dimensions are exact and supersede inch conversions.

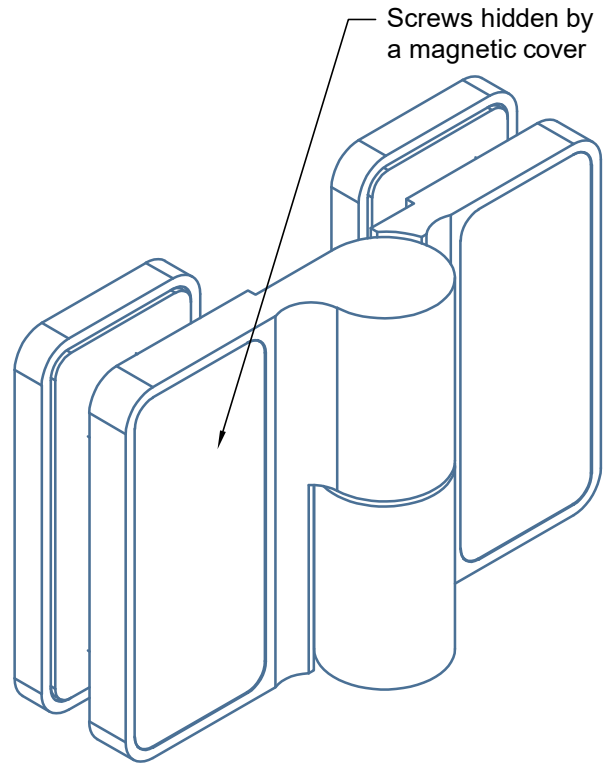

*See specification

Pivot Hinge [DU.3341] Glass to Glass - 180° with seal

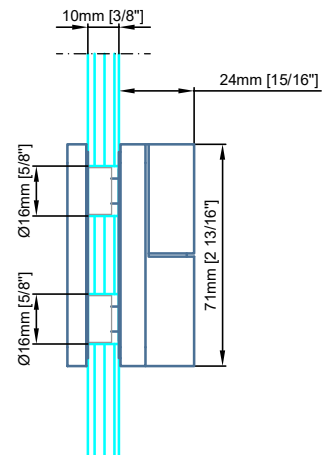

Spirit GGP

DU.3341

Glass to Glass - 180°

Date Prepared: Nov 2018

Prepared By: CDA | JRT

MWE
NORTH AMERICA

Email: info@mwe-na.com
www.mwe-na.com

Load capacity 110lbs
Max. door width 1000mm [39 3/8"]

Illustrated

Right Hinge

Suitable for 8mm [5/16"] - 10mm [3/8"] - 12mm [1/2"] glass

Reference:

3 hinges required for door height at or above 2600mm [102 3/8"]
Third hinge positioned in the upper third of door

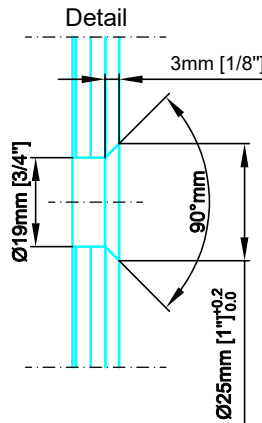
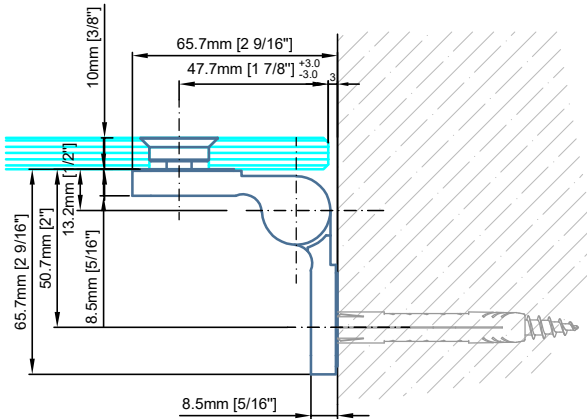

Shown in the open position.
Door lifted max. 6mm [1/4"]

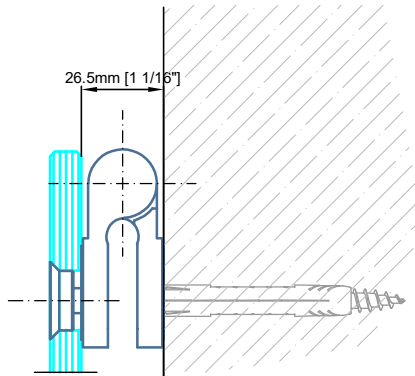
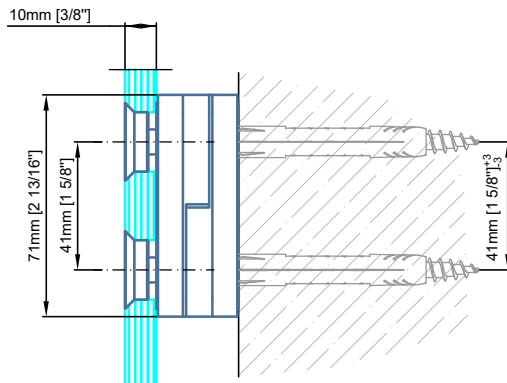

Copyright MWE NA Inc., all rights reserved. Reproduction or other use of these designs without written consent from MWE NA Inc. is prohibited.

Technical drawings are subject to change without notice.
All millimeter dimensions are exact and supersede inch conversions.

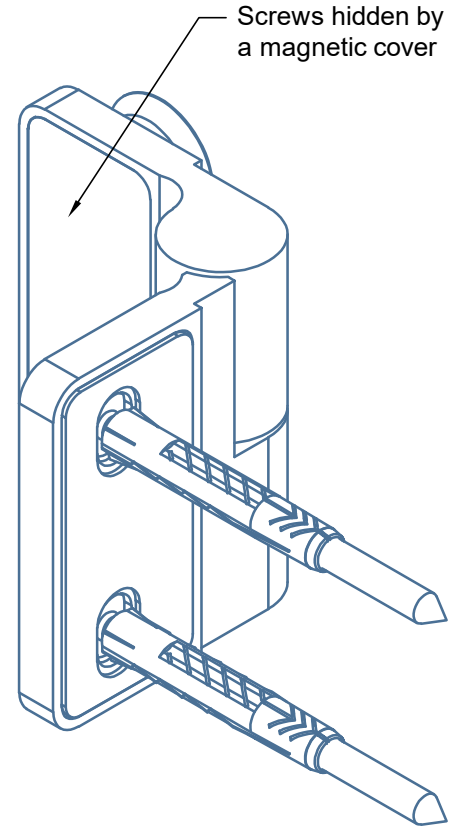

*See specification

Pivot Hinge [DU.3342] Glass to Wall - 90° with seal

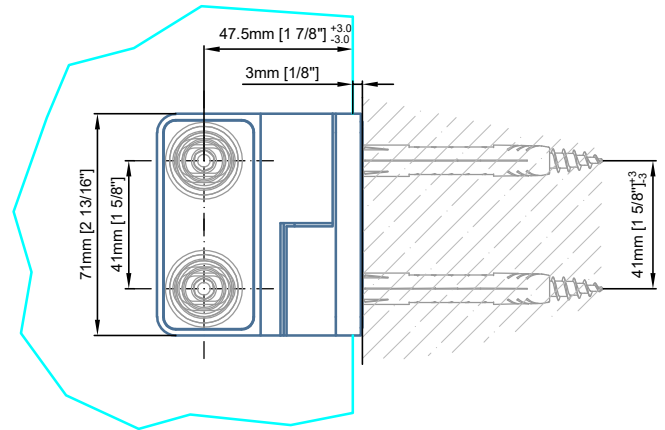

Spirit WGS

DU.3342

Glass to Wall - 90°

Date Prepared: Nov 2018

Prepared By: CDA | JRT

MWE
NORTH AMERICA

Email: info@mwe-na.com
www.mwe-na.com

Load capacity 110lbs
Max. door width 1000mm [39 3/8"]

Illustrated

Right Hinge

Suitable for 8mm [5/16"] - 10mm [3/8"] - 12mm [1/2"] glass

Reference:

3 hinges required for door height at or above 2600mm [102 3/8"]
Third hinge positioned in the upper third of door

Copyright MWE NA Inc., all rights reserved. Reproduction or other use of these designs without written consent from MWE NA Inc. is prohibited.

Technical drawings are subject to change without notice.
All millimeter dimensions are exact and supersede inch conversions.

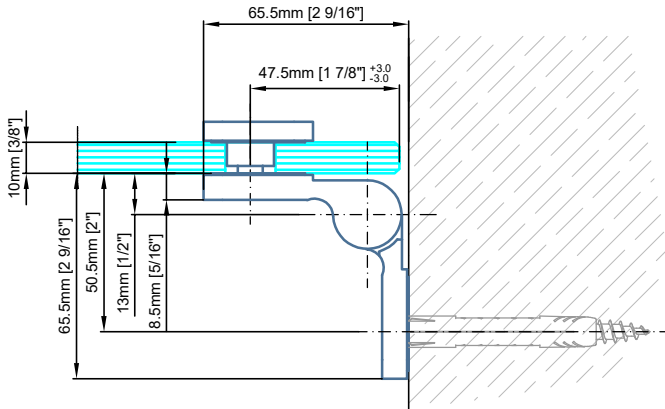

Shown in the open position.
Door lifted max. 6mm [1/4"]

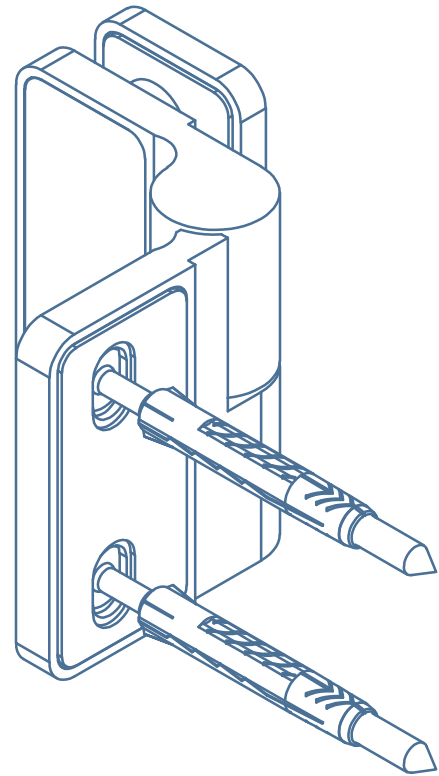
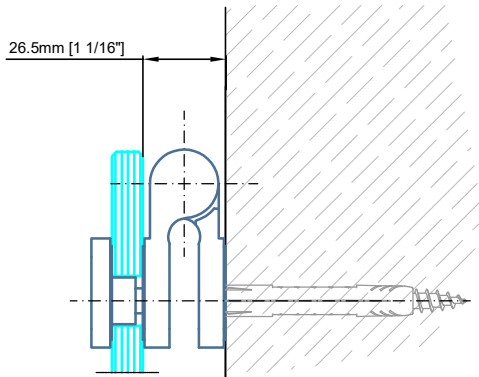
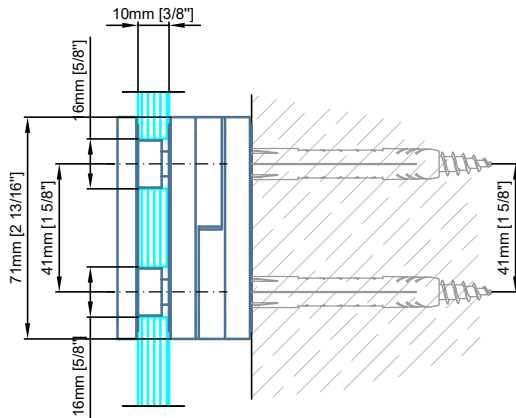

*See specification
Pivot Hinge [DU.3343] Glass to Wall] - 90° *with seal*

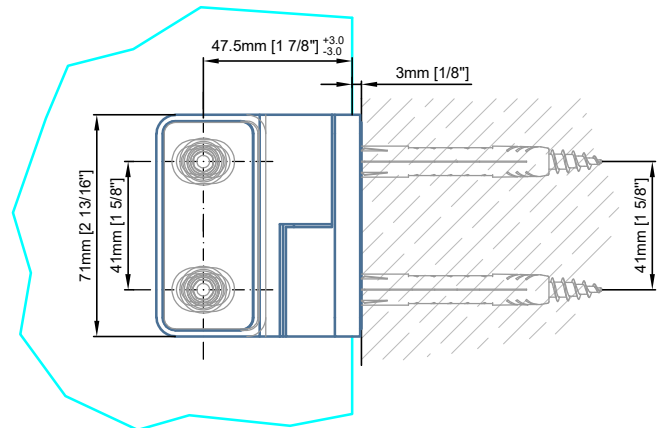

Spirit WGP

DU.3343

Glass to Glass - 90°

Date Prepared: Nov 2018

Prepared By: CDA | JRT

MWE
NORTH AMERICA

Email: info@mwe-na.com
www.mwe-na.com